

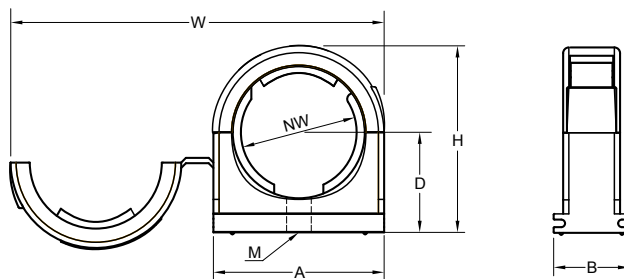

- High-grade formulated polyamide
- Self-extinguishing, free from halogens and cadmium
- Excellent impact strength
- Temperature range: -40°C(-40°F) to 105°C(221°F)
- Short-term to 160°C(320°F)
- Colour: Black standard, other colours available upon request
- One-piece tube clamp with integrated safety clip
- Especially suitable for reverse overhead installations
- Fits both profile conduits C (Coarse) / F (Fine)
- Fits to support rail TCR

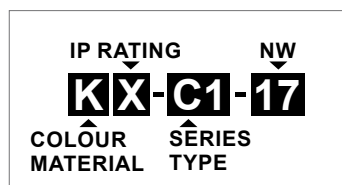

Specifications are subject to change without notice

Order No.	Fits to Conduit			A		B		D		H		W		M
	NW	mm	in	mm	in	mm	in	mm	in	mm	in	mm	in	mm
KX-C1-07	7	10	1/4	17.0	0.67	20.0	0.79	13.1	0.52	21.8	0.86	40.0	1.57	4.0
KX-C1-10	10	12	5/6	21.0	0.83	20.0	0.79	15.0	0.59	25.7	1.01	48.0	1.89	5.0
KX-C1-12	12	16	3/8	24.0	0.94	20.0	0.79	16.4	0.65	28.6	1.13	54.0	2.13	5.0
KX-C1-17	17	20	1/2	30.0	1.18	20.0	0.79	19.7	0.78	34.9	1.37	68.0	2.68	6.0
KX-C1-23	23	25	3/4	38.0	1.50	20.0	0.79	23.3	0.92	42.5	1.67	84.0	3.31	6.0
KX-C1-29	29	32	1	45.0	1.77	20.0	0.79	26.4	1.04	49.0	1.93	98.0	3.86	6.0
KX-C1-36	36	40	1-1/4	55.0	2.17	20.0	0.79	30.2	1.19	58.0	2.28	118.0	4.65	6.0
KX-C1-48	48	50	1-1/2	67.5	2.66	20.0	0.79	36.3	1.43	70.3	2.77	143.0	5.63	6.0