

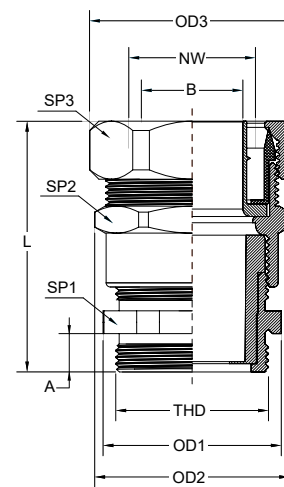

- For conduits type:  
**L, P, DAR, SVT, T/TP, LPU, DAPU & SVPEVAT**
- Nickel-plated brass
- Temperature range: -40°C(-40°F) to 105°C(221°F)
- **UL** File E-124066
- Up to IP67

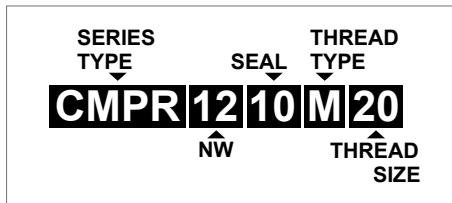

Specifications are subject to change without notice

**METRIC  
METAL  
THREAD**

Order No.	Conduit		Cable Range	Seal Colour	A		B		L		OD1		OD2		OD3		SP1		SP2		SP3	
	Metric	NW			mm	mm	in	mm	in	mm	in	mm	in	mm	in	mm	in	mm	in	mm	in	mm
CMPR1006M16	M16x1.5	10	4 - 6.5	Yellow	8.0	0.31	8.5	0.33	44.0	1.73	21.0	0.83	25.0	0.98	26.0	1.02	19.0	0.75	22.0	0.87	24.0	0.94
CMPR1008M16			5 - 8	Grey																		
CMPR1208M20	M20X1.5	12	5 - 8	Grey	8.0	0.31	10.5	0.41	45.0	1.77	24.0	0.94	27.5	1.08	29.0	1.14	22.0	0.87	24.0	0.94	26.0	1.02
CMPR1209M20			6.5 - 9.5	Black																		
CMPR1210M20			7 - 10.5	Green																		
CMPR1509M20	M20X1.5	15	6.5 - 9.5	Black	8.0	0.31	13.8	0.54	45.0	1.77	24.0	0.94	32.0	1.26	33.0	1.30	22.0	0.87	28.0	1.10	30.0	1.18
CMPR1510M20			7 - 10.5	Green																		
CMPR1513M20			9 - 13	Red																		
CMPR1509M25	M25X1.5	15	6.5 - 9.5	Black	9.0	0.35	13.8	0.54	47.5	1.87	30.0	1.18	32.0	1.26	33.0	1.30	28.0	1.10	28.0	1.10	30.0	1.18
CMPR1510M25			7 - 10.5	Green																		
CMPR1513M25			9 - 13	Red																		
CMPR2018M25	M25X1.5	20	14 - 18	Blue	9.0	0.35	18.5	0.73	52.0	2.05	33.0	1.30	39.0	1.54	42.5	1.67	30.0	1.18	35.0	1.38	38.0	1.50
CMPR2718M32	M32X1.5	27	14 - 18	Blue	10.0	0.39	25.0	0.98	54.5	2.15	37.5	1.48	45.0	1.77	49.5	1.95	35.0	1.38	42.0	1.65	45.0	1.77
CMPR2720M32			17 - 20.5	Brown																		
CMPR2725M32			20 - 25	Orange																		
CMPR3530M40	M40X1.5	35	26 - 30	White	10.0	0.39	33.0	1.30	65.0	2.56	48.0	1.89	55.0	2.17	58.0	2.28	45.0	1.77	50.0	1.97	53.0	2.09
CMPR4032M50	M50X1.5	40	27 - 32	Anthracite	12.0	0.47	37.5	1.48	64.0	2.52	57.0	2.24	64.0	2.52	66.5	2.62	52.0	2.05	58.0	2.28	61.0	2.40
CMPR4034M50			29 - 34	Light blue																		
CMPR4036M50			32 - 36	Pink																		
CMPR5045M63	M63X1.5	50	39 - 44	White	10.0	0.39	48.0	1.89	69.0	2.72	70.0	2.76	76.0	2.99	80.5	3.17	64.0	2.52	70.0	2.76	74.0	2.91