

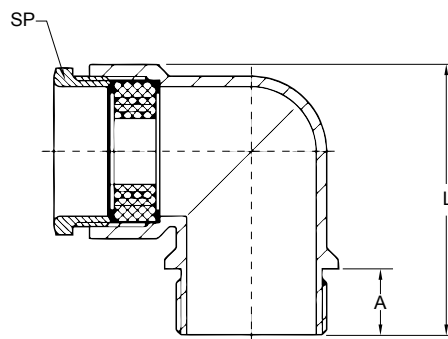

- For application in installation areas with small amounts of space.
- Polyamide PA6 GF30
- SBR/NBR, multiple perforation Sealing ring
- Steel, zinc-plated Washer
- IP 55 rating to the cable and pressure screw
- Temperature range: -20°C (-4°F) to 100°C (212°F)

IP RATING	SERIES	THD.	SIZE
<b>W5-GE-J-M20-10</b>			
COLOUR MATERIAL	TYPE	THD. TYPE	MAX. CABLE RANGE



Specifications are subject to change without notice

**METRIC  
THREAD**

Order No.	THD	Cable Range	A		SP		L	
			mm	in	mm	in	mm	in
W5-GE-J-M16-9	M16x1.5	5 - 9	12.0	0.47	16.0	0.63	38.0	1.50
W5-GE-J-M20-12	M20x1.5	7 - 12	12.0	0.47	20.0	0.79	42.0	1.65
W5-GE-J-M25-15	M25x1.5	8.5 - 15	12.0	0.47	25.0	0.98	48.5	1.91
W5-GE-J-M32-20	M32x1.5	14 - 20	12.0	0.47	32.0	1.26	57.5	2.26