

These fittings are used in the adaptation of parts to an application in order to work together as a unit. They are commonly made by using a female (inner) to a male (outer) thread combination on each part.



**SIZE SIZE MATERIAL**  
**P 16 N 06 MA**

**MALE FEMALE**  
**THREAD THREAD**  
**TYPE TYPE**

**M** → RAW ALUMINUM  
**MA** → NICKEL PLATED ALUMINUM  
**MAB** → BLACK ANODIZED ALUMINUM  
**B** → BRASS METAL  
**MB** → NICKEL PLATED BRASS  
**MBR** → CHROME PLATED BRASS  
**N** → NYLON  
**SS** → STAINLESS STEEL

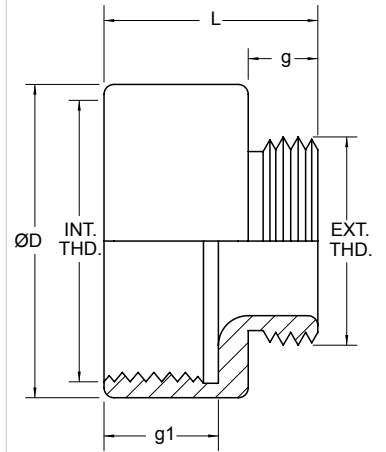

Specifications are subject to change without notice

**FROM PG TO NPT THREAD**

Order Number	EXT. THD.	INT. THD.	Ø D		L		g		g1	
			mm	in	mm	in	mm	in	mm	in
P09N01MA	PG 9	NPT 3/8"	20.0	0.79	22.5	0.89	6.0	0.24	15.0	0.59
P11N01MA	PG 11	NPT 3/8"	20.0	0.79	22.5	0.89	6.0	0.24	14.0	0.55
P13N01MA	PG 13	NPT 3/8"	23.0	0.91	19.5	0.77	6.0	0.24	14.0	0.55
P07N02MA	PG 7	NPT 1/2"	24.0	0.94	24.0	0.94	6.0	0.24	15.5	0.61
P09N02MA	PG 9	NPT 1/2"	24.0	0.94	24.0	0.94	6.0	0.24	16.0	0.63
P11N02MA	PG 11	NPT 1/2"	24.0	0.94	24.0	0.94	6.5	0.26	16.0	0.63
P13N02MA	PG 13	NPT 1/2"	24.0	0.94	24.5	0.96	6.5	0.26	16.0	0.63
P16N02MA	PG 16	NPT 1/2"	24.0	0.94	24.5	0.96	6.5	0.26	17.0	0.67
P09N04MA	PG 9	NPT 3/4"	30.0	1.18	24.0	0.94	6.0	0.24	16.0	0.63
P11N04MA	PG 11	NPT 3/4"	30.0	1.18	24.0	0.94	6.0	0.24	16.0	0.63
P13N04MA	PG 13	NPT 3/4"	30.0	1.18	24.5	0.96	6.5	0.26	16.0	0.63
P16N04MA	PG 16	NPT 3/4"	30.0	1.18	24.5	0.96	6.5	0.26	16.0	0.63
P21N04MA	PG 21	NPT 3/4"	30.0	1.18	22.0	0.87	7.0	0.28	14.0	0.55
P11N06MA	PG 11	NPT 1"	36.0	1.42	24.5	0.96	6.0	0.24	17.0	0.67
P13N06MA	PG 13	NPT 1"	36.0	1.42	26.0	1.02	6.5	0.26	18.0	0.71
P16N06MA	PG 16	NPT 1"	37.0	1.46	26.0	1.02	6.5	0.26	18.0	0.71
P21N06MA	PG 21	NPT 1"	36.0	1.42	25.5	1.00	7.0	0.28	17.0	0.67
P29N06MA	PG 29	NPT 1"	41.0	1.61	26.0	1.02	8.0	0.31	17.0	0.67
P16N07MA	PG 16	NPT 1-1/4"	44.0	1.73	27.5	1.08	6.5	0.26	19.0	0.75
P21N07MA	PG 21	NPT 1-1/4"	44.0	1.73	28.0	1.10	7.0	0.28	19.0	0.75
P29N07MA	PG 29	NPT 1-1/4"	44.0	1.73	29.0	1.14	8.0	0.31	18.0	0.71
P16N08MA	PG 16	NPT 1-1/2"	50.0	1.97	28.5	1.12	6.5	0.26	20.0	0.79
P36N07MA	PG 36	NPT 1-1/4"	50.0	1.97	29.0	1.14	9.0	0.35	18.0	0.71
P36N08MA	PG 36	NPT 1-1/2"	50.0	1.97	31.0	1.22	9.0	0.35	20.0	0.79
P21N08MA	PG 21	NPT 1-1/2"	50.0	1.97	29.0	1.14	7.0	0.28	20.0	0.79
P29N08MA	PG 29	NPT 1-1/2"	51.0	2.01	30.0	1.18	8.0	0.31	20.0	0.79
P16N09MA	PG 16	NPT 2"	64.0	2.52	28.5	1.12	6.5	0.26	20.0	0.79
P21N09MA	PG 21	NPT 2"	64.0	2.52	29.0	1.14	7.0	0.28	20.0	0.79
P29N09MA	PG 29	NPT 2"	64.0	2.52	31.0	1.22	8.0	0.31	20.0	0.79
P36N09MA	PG 36	NPT 2"	64.0	2.52	31.0	1.22	9.0	0.35	20.0	0.79
P42N09MA	PG 42	NPT 2"	64.0	2.52	33.0	1.30	10.0	0.39	20.0	0.79
P48N09MA	PG 48	NPT 2"	64.0	2.52	33.0	1.30	10.0	0.39	20.0	0.79