

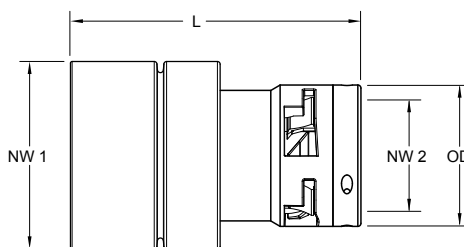

- Locking device system provides a quick and secure push-in connection of corrugated conduits
- High-grade formulated polyamide
- Self-extinguishing, free from halogens and cadmium
- Excellent impact strength
- Temperature range: -40°C(-40°F) to 105°C(221°F)
- Short-term to 160°C(320°F)
- Up to IP68 / NEMA 6P protection with the reinforced sealing cap at conduit side
- Colour: Black standard, other colours available upon request



Specifications are subject to change without notice

	Order No.	Order No.	Fits to Conduit		L		OD	
	IP66	IP68	NW 1	NW 2	mm	in	mm	in
	K6-TR-1007	K8-TR-1007	10	7	49.5	1.95	17.0	0.67
Ⓢ	K6-TR-1210	K8-TR-1210	12	10	54.5	2.15	20.0	0.79
Ⓢ	K6-TR-1710	K8-TR-1710	17	10	50.5	1.99	20.0	0.79
Ⓢ	K6-TR-2310	K8-TR-2310	23	10	54.5	2.15	20.0	0.79
Ⓢ	K6-TR-2910	K8-TR-2910	29	10	54.0	2.13	20.0	0.79
Ⓢ	K6-TR-1712	K8-TR-1712	17	12	53.5	2.11	24.0	0.94
Ⓢ	K6-TR-2312	K8-TR-2312	23	12	57.5	2.26	24.0	0.94
Ⓢ	K6-TR-2912	K8-TR-2912	29	12	57.0	2.24	24.0	0.94
Ⓢ	K6-TR-2317	K8-TR-2317	23	17	59.0	2.32	30.0	1.18
Ⓢ	K6-TR-2917	K8-TR-2917	29	17	58.5	2.30	30.0	1.18
Ⓢ	K6-TR-2923	K8-TR-2923	29	23	67.5	2.66	38.0	1.50
Ⓢ	K6-TR-3623	K8-TR-3623	36	23	74.0	2.91	38.0	1.50
Ⓢ	K6-TR-3629	K8-TR-3629	36	29	75.0	2.95	45.5	1.79
Ⓢ	K6-TR-4829	K8-TR-4829	48	29	78.0	3.07	45.5	1.79
Ⓢ	K6-TR-4836	K8-TR-4836	48	36	86.0	3.39	57.0	2.24