

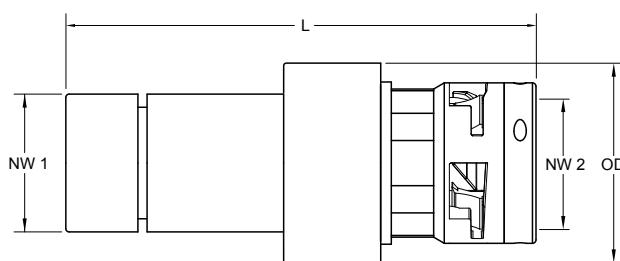

- Locking device system provides a quick and secure push-in connection of corrugated conduits
- High-grade formulated polyamide
- Self-extinguishing, free from halogens and cadmium
- Excellent impact strength
- Temperature range: -40°C(-40°F) to 105°C(221°F)
- Short-term to 160°C(320°F)
- Up to IP68 / NEMA 6P protection with the reinforced sealing cap at conduit side
- Colour: Black

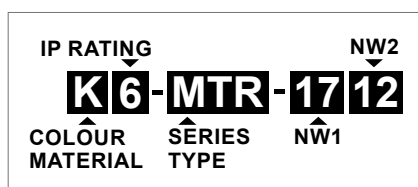

Specifications are subject to change without notice

Order No.	Order No.	Fits to Conduit		L		OD	
		NW 1	NW 2	mm	in	mm	in
		IP66	IP68				
K6-MTR-1007	K8-MTR-1007	10	7	68.5	2.70	20.0	0.79
K6-MTR-1207	K8-MTR-1207	12	7	72.0	2.83	24.0	0.94
K6-MTR-1210	K8-MTR-1210	12	10	73.0	2.87	24.0	0.94
K6-MTR-1707	K8-MTR-1707	17	7	73.0	2.87	30.0	1.18
K6-MTR-1710	K8-MTR-1710	17	10	74.5	2.93	30.0	1.18
K6-MTR-1712	K8-MTR-1712	17	12	77.5	3.05	30.0	1.18
K6-MTR-2307	K8-MTR-2307	23	7	82.0	3.23	38.0	1.50
K6-MTR-2310	K8-MTR-2310	23	10	84.5	3.33	38.0	1.50
K6-MTR-2312	K8-MTR-2312	23	12	87.5	3.44	38.0	1.50
K6-MTR-2317	K8-MTR-2317	23	17	89.0	3.50	38.0	1.50
K6-MTR-2910	K8-MTR-2910	29	10	86.5	3.41	45.5	1.79
K6-MTR-2912	K8-MTR-2912	29	12	89.5	3.52	45.5	1.79
K6-MTR-2917	K8-MTR-2917	29	17	91.0	3.58	45.5	1.79
K6-MTR-2923	K8-MTR-2923	29	23	100.0	3.94	45.5	1.79
K6-MTR-3629	K8-MTR-3629	36	29	110.0	4.33	57.0	2.24
K6-MTR-4836	K8-MTR-4836	48	36	126.5	4.98	68.0	2.68